

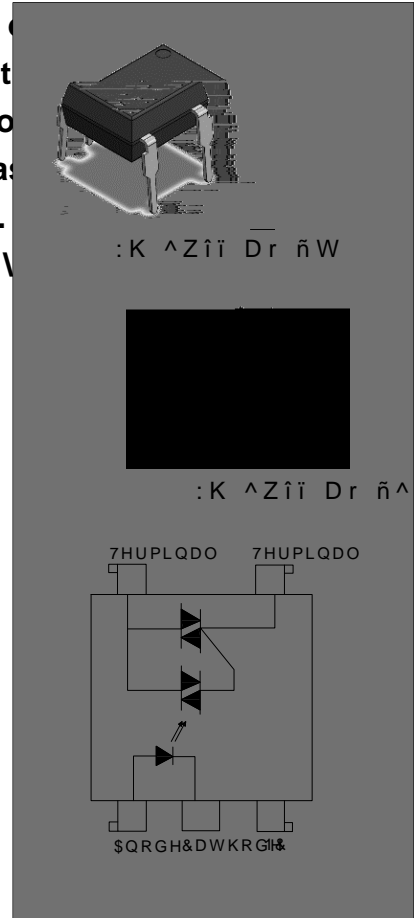

59 o/k Lt u L \ b

The products are 5-pin solid-state relay opto-couplers. The device combines an AlGaAs infrared emitting diode as the emitter which is optically coupled to a monolithic silicon random-phase photo triac to drive a power triac in a plastic DIP5 package with different lead form options. The products are widely used in solenoid/valve controls, lighting controls, motor controls, temperature controls, static AC power switches, solid state relays, interfacing microprocessors to 265V peripherals.



a ° Lb C9 ° u y k 9 o

- < i [\ isolati 5000 Vrms
- DC input kit \ triac output
- Operatin [temperature ran [40 š C to 110 š C
- REAC < / Ro < S compliance
- < BM: < 3B / MM: M4 / CDM: C3
- CEC approved
- VDE approved
- UL approved

° .o \ O y u 9 a ° CELaya kfi TempDure 1 25 š CŁ

Parameter		Symbol	Value	Unit	
Input	Forward Current	I_F	50	mA	
	Peak Forward Current	I_{FP}	1	A	
	Reverse Voltage	V_R	6	V	
	Power Dissipation	P_D	75	mW	
Output	Repetitive peak on-state voltage	V_{DRM}	600	V	
	Repetitive peak reverse voltage	V_{RRM}	600	V	
	Critical rate of rise of state current	di/dt	100	A/ s	
	On-state RMS Current	$I_{T(RMS)}$	0.8	A	
	1 R Q U H S H W J L W I S Y H D N X R Q V W D W H				
	F X U U H Q W I X O P V F \ F O H W ⁷⁶⁰				
M X Q F W L R Q W R F D V H \$ & 5 W K M F				:	

\ k 59 k LbD LbC \ ka ° uL \ b

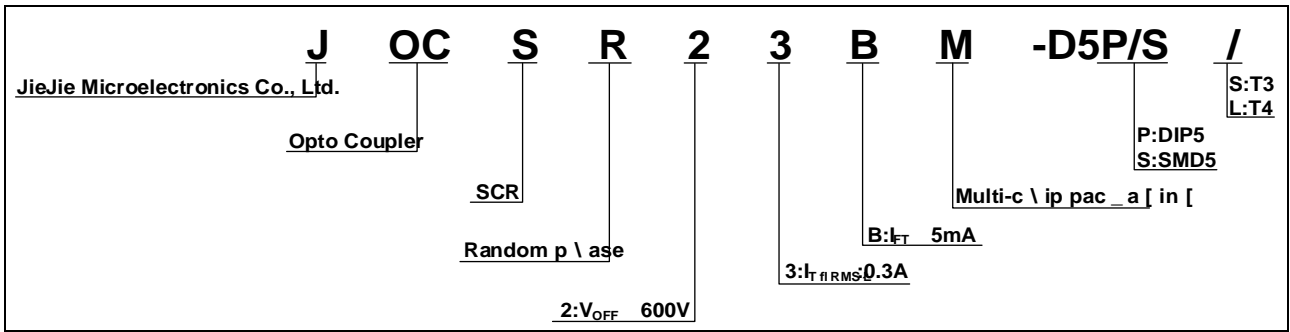

t v	
\	v
5Lt	y u
o a5	y k

a ° k MLbD

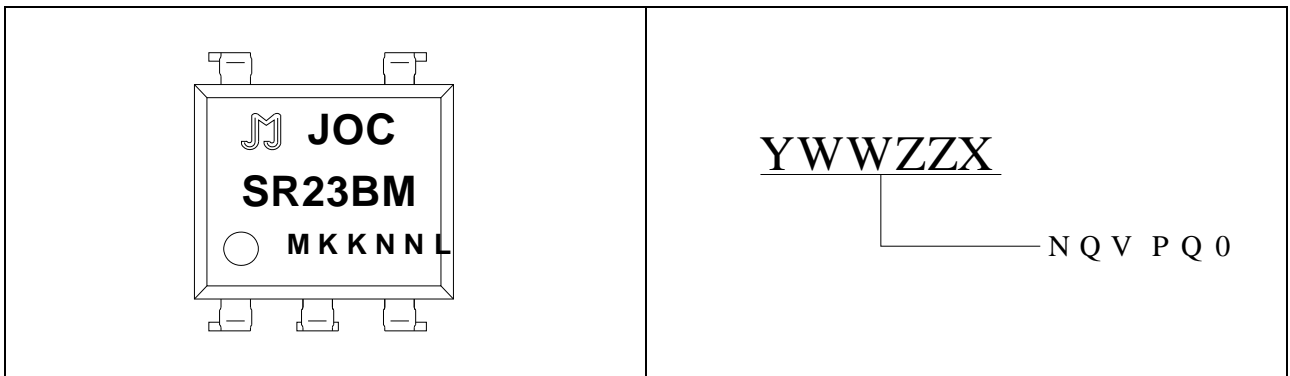

/

/

FIG.1: Max. Allowable LED Forward Current vs. Ambient Temperature

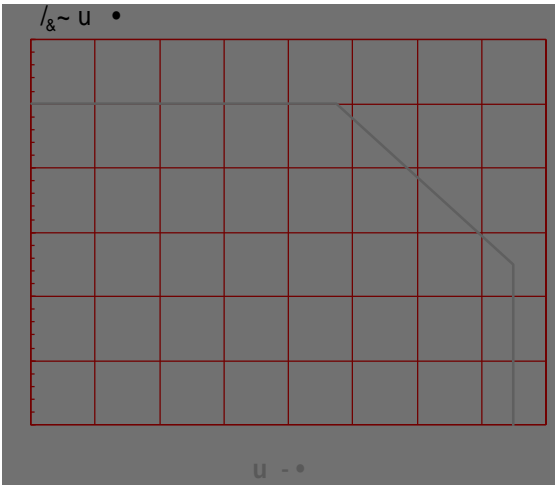

FIG.2: On-state Terminal Current vs. Ambient Temperature

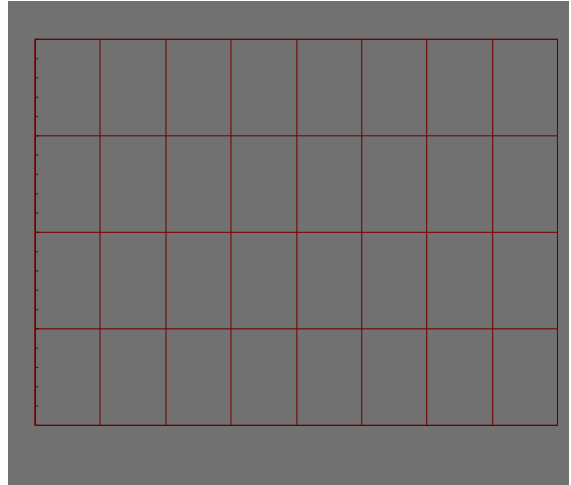

FIG.7: On-state characteristics

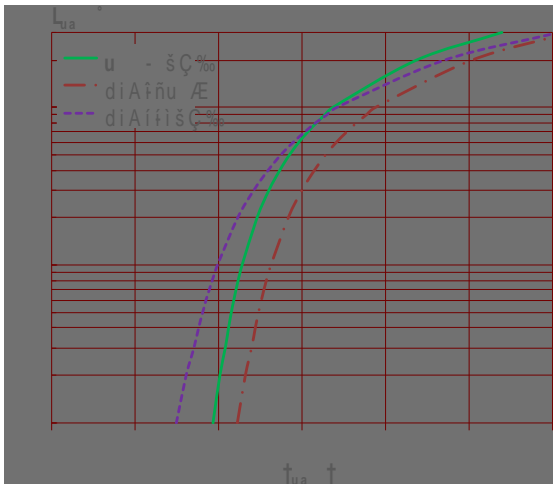

FIG.8: Normalized β_{oldin} [Current vs. Ambient Temperature

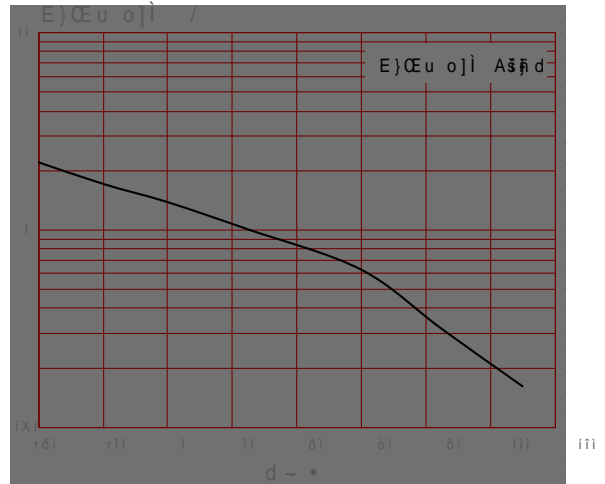
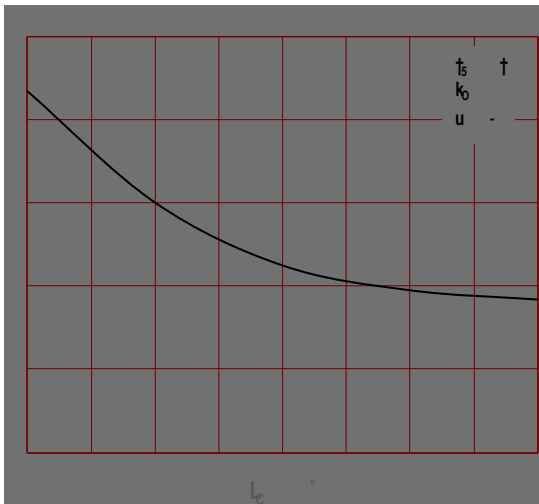

FIG.9: Turn On Time vs. Forward Current



t 5

y

Standard DIP Type:

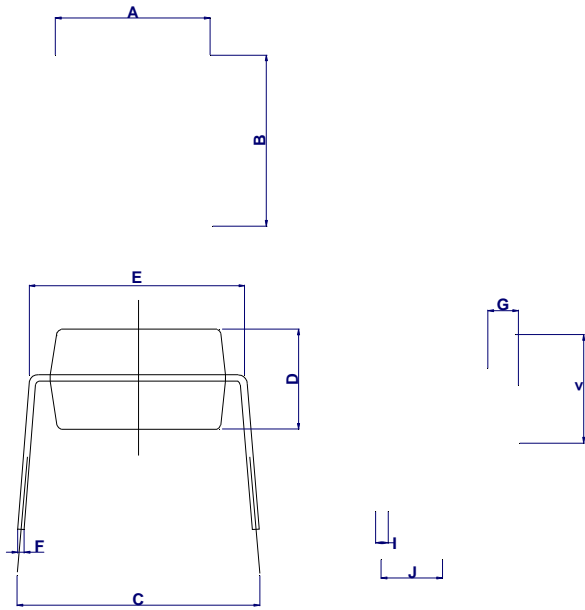

Dimensions

Millimeters

Inchio

Option SMD

Option SMD

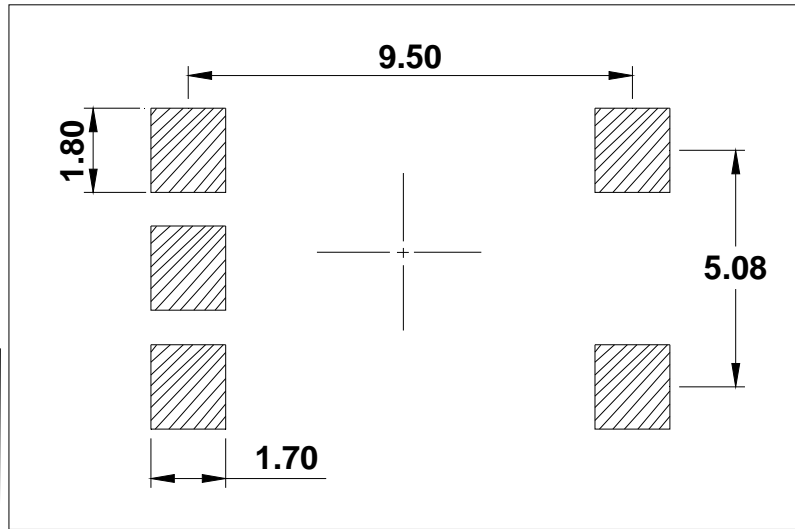

Standard DIP

Standard DIP

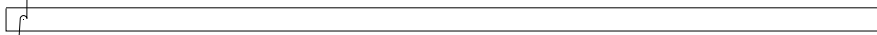
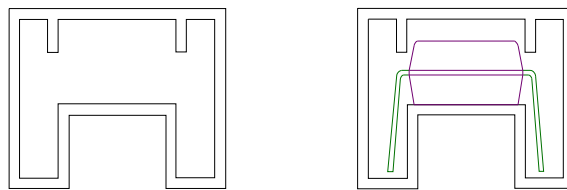

‡ ° †9 o \ O59 k LbD

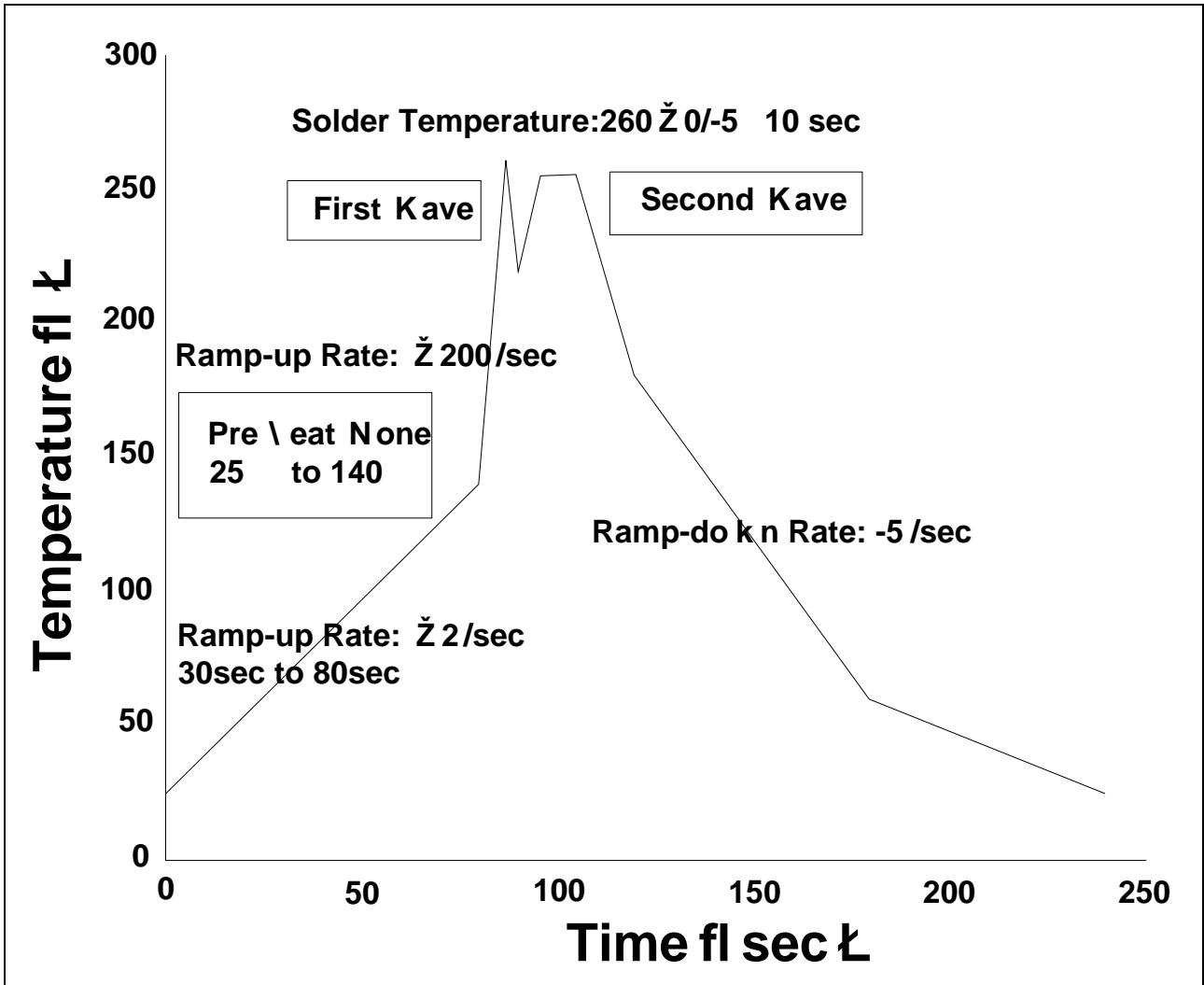

I ° b5 o \ O59 k LbD . ' o \ O59 k LbD L k \ b	
Solderin [Temperature	360w5
Solderin [Time	3s max.

Note:

1. Re Z lo k solderin [is recended at t \ e temperatures and times s \ o k n, no manett\ree times.
2. Avoid direct contact bet k eeñ e epoxy body and any tools osur Z aces exceedin [its maximum stora [e temperature.
3. Applicatiã o Z psure on t \ e epoxy body Q