



JOCMC35C-M4

Rev.A.1.0

DESCRIPTION:

7KH SURGXFWV DUH SLQ RSWLFDQ QHOD\ 7KH GHYLFH F
\$O*D\$V LQIUUDHG HPSXWLVQVGDHRCGSHWLFDOO\ FRXSOHG WR D
KLJK YROWDJH RXWLSXWLQGHVSDVWRWLFLOZ3 SDFNDJH
7KH GHWHFWRU FRQVLVWV RI D KLJK VSHHG SKRWRYROWDL
DQG GULYHU FLUFXLWUH ZLGH SURGXFWLQ PHDVXULQJ
DQG WHVWLQJ HTXLSHLODVVWHHSULWHHDOQLRQ PDUNHW
LQGXVWULDO PDFKLQHU\ DQG HTXLSPHQW

MAIN FEATURES

- +LJK LVRODWLURFQ
- 2SHUDWLQJ WHPSHUJHWXU& WR f&
- 5(\$&+ 5R+6 FRPSOLDQFH
- +%0 + \$ 00 0 &'0 &
- &4& DSSURYHG
- 9'(DSSURYHG
- 8/ DSSURYHG

ABSOLUTE MAXIMUM RATINGS 7HP SHUDWXUH f&

Parameter	Symbol	Value	Unit
)RUZDUG &XUUHQW ,)			
3HDN)RUZDUG &XUUHQW		7	\$
5HYHUVH 9ROWDJH 9s			

,QSXW 3RZHU 'LVVLSDWLRQ 3

NOTE1 $f_{osc} = \frac{1}{2 \times (C_{in} + C_{out})}$

NOTE2 $f_{osc} = \frac{1}{2 \times (C_{in} + C_{out})}$

ELECTRICAL CHARACTERISTICS $f_{osc} = 100\text{kHz}$

Parameter	Symbol	Condition	Min.	Typ.	Max.	Unit
, Q _{SXW}	$V_{DD} - V_{OL}$	$V_{DD} = 1.8\text{V}$				V
	$V_{DD} - V_{OH}$	$V_{DD} = 1.8\text{V}$		0.9		V
	V_{IL}	$V_{DD} = 1.8\text{V}$				V
	V_{IH}	$V_{DD} = 1.8\text{V}$				V
2XWSXW	t_{PLH}	$V_{DD} = 1.8\text{V}$: LWK LQ V RQ W LPH				ns
	t_{PD}	$V_{DD} = 1.8\text{V}$ / HDNDJH & XUUH _{QW}				ns
6ZLWFKL & KDUDFW	t_{RST}	$V_{DD} = 1.8\text{V}$ 5, 6, 2				ns
	t_{RST}	$V_{DD} = 1.8\text{V}$ & 2				ns
	t_{RST}	$V_{DD} = 1.8\text{V}$ 7XUQ 2Q 7LPH W_Q				ns
	t_{RST}	$V_{DD} = 1.8\text{V}$ 7XUQ 2II 7LPH W_{II}				ns

ORDERING INFORMATION

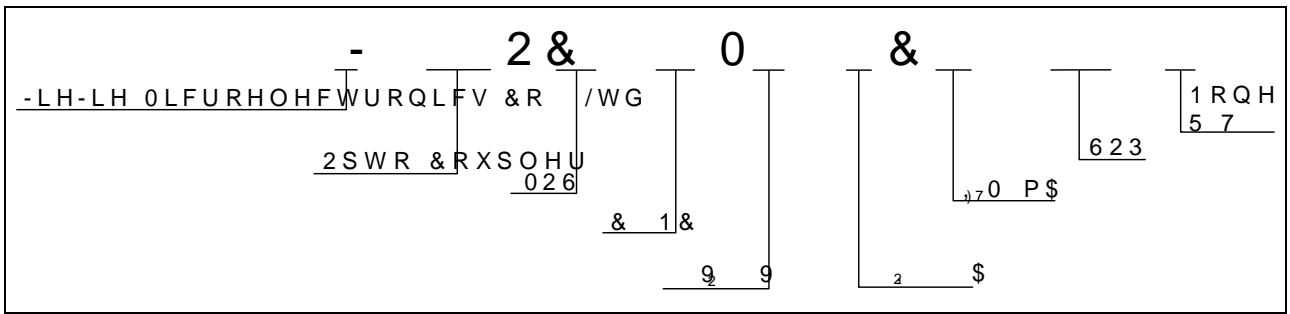

&

Packing Quantity	
Option	Quantity
E } v I Z	ï ï ï h v] š • I Z o

MARKING



Characteristics Curves

FIG.1: /(' 'URSRXW 9ROWDJH YV \$P EFIG.2 WXWSXW &XUUHQW YV 2XWSXV
7HP SHUDWXUH

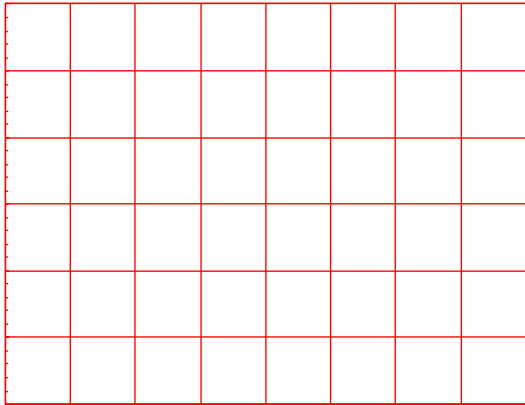
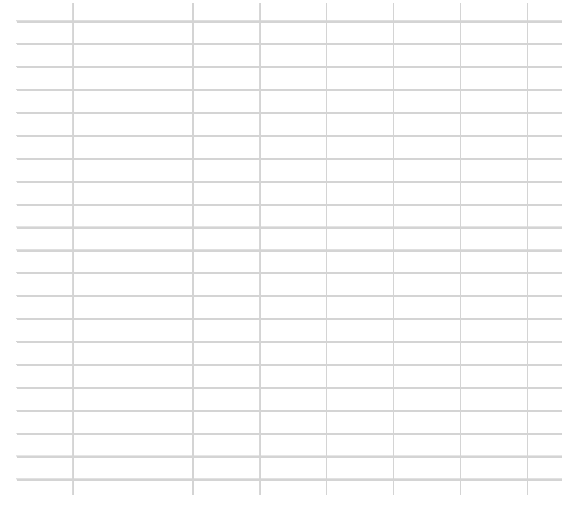
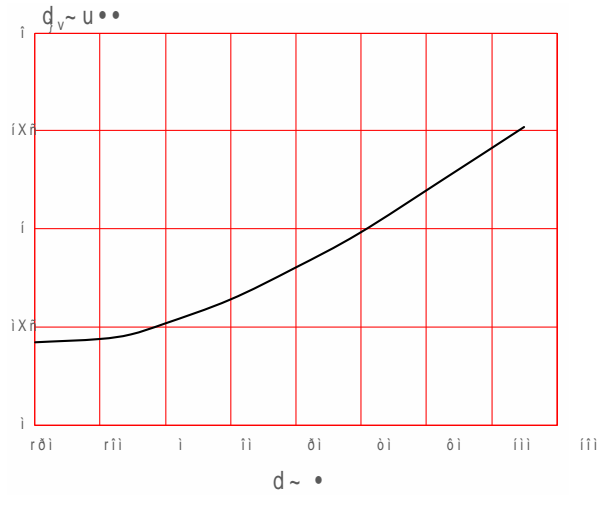
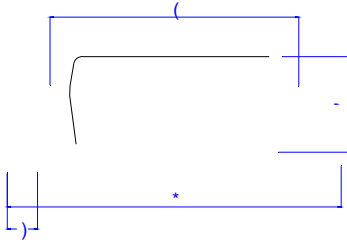
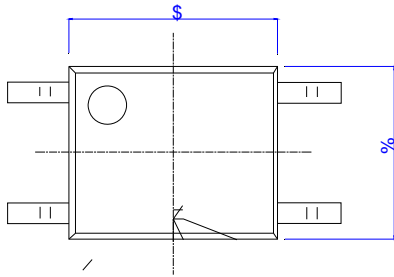

FIG.7: 7XUQ 2Q 7LPH YV \$PELHQW 7HPSHUDWXUH 7HPSHUDWXUH 7LPH YV \$PELHQW 7HPSHUDWXUH



Package Dimension (Unit: mm)



5HI	'LPHQVLRQV					
	0LOOLPHWHUV			,QFKHV		
	0LQ	7\ S	0D[0LQ	7\ S	0D[
\$						
%						
&						
'						
(
)						
*						
+						
,						
-						

CARRIER TAPE SPECIFICATIONS (Dimensions in mm unless otherwise stated)

Option None

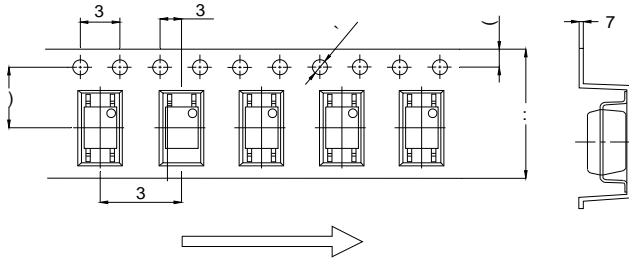

5 HI	'LPHQVLRQV					
	0LOOLPHWHUV ,QFKHV					
	0LQ	7\S	0D[0LQ	7\S	0D[
,						
3						
3						
3						
(
)						
7						
:						

REFLOW INFORMATION

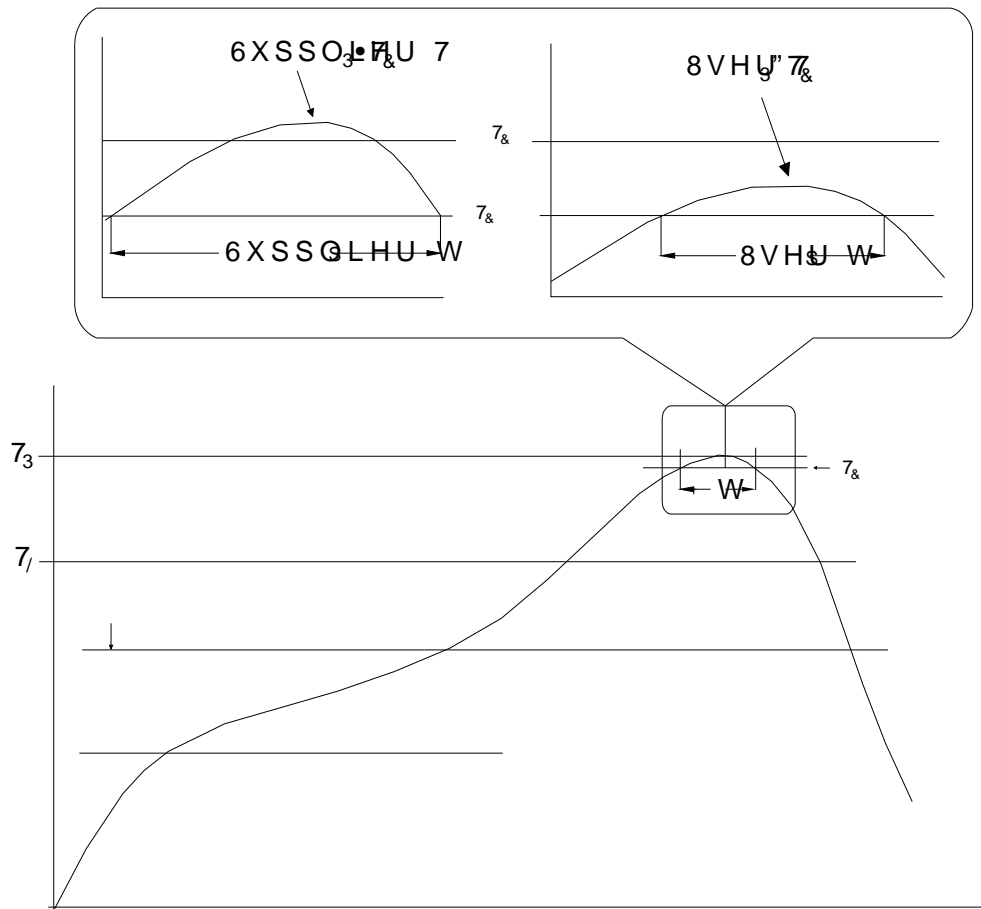

1RWH

5HIORZ VROGHULQJ LV UHFRPPHQGHG/ DWRZKH QHPSHWDWWDQW DQW DQ
\$YRLG GLUHFV FRQVHDVSRPHQZDQWWRUDFRU H[FHHGLQJ LWV PD
VWRUDJH WHPSHUDWXUH

\$SSOLFDWLRQ RKHUSRYXENRQLVLSOHGDDWHG WHPSHUDWXUHV ,QV
VFHQDULRV DQHPSVOLGRWRHFFHHG 1

(QVXUH WKH FRPSRQHQW KDV FRROHG SURFHQWVWKDQZLXPSWHDXHCL
PDQXIDFWXULQJ VWHSV

7KH FRPSRQHQW KDV BQKHODUZKHQVWDQGHGKFRQGLWLRQV

5HFRPPHQG VWRUDJH 7HPS a f&

5HFRPPHQG VWRUDJH KXPLGLW\

06/ OHYHO 06/

,QIRUPDWLRQ IXUQXPHQW/ LQ WKOLHGRHG WR EH DFFXUDWH D
-LDQJVVX -LH-LH 0LRRHOWHG WDVROLFFVQLRVUHRUSRQHLERQVHT
RI XVH ZLWKRXW FRQVLGHUDWLRQ IRG MWFKQIRUPDWLRQ
LQ WKLV GRFXPHQW LQJYXZLWHFRXWRQRWLFH DSDUW IURP V
VLJQHGH -LDQJVVXOLHVLZLFRKPKH DJUHHPHQW

3URGXFWV DQG LQIRUPDWLRQ SURYLGHG LQHWKWRG RSDXPH
-LDQJVVX -LH-LH DVVXPHLOQR\URVSRQVLQIULQJHPPHQW RI RW
ZKLFK PD\ UHVXOW IURP WKH XVH RI VXLW SURFXPHQW DQGS HL
DQG UHSODFHV DOO LQIRUPDWLRQ SUHYLRXVO\ VXSSOLHG

 LV D UHJLVWHUHGDQJJDGHLPHUN RUF-URHOWHG WURQLFV & R
&RS\ULJKW -LDQJVVX -LH-LH CLV & RHOWHG USRQHLGLJKWV UHVH